

## CONCRETE SPA JET (50mmx50mm air & water)

**CODE : 00590050**



**The concrete SPA JET is intended to use in concrete SPA, but also can be used in Fiberglass, wooden , standless SPA.**

### INSTALLATION

1. Mark the under water install level.
2. Drill a hole at the marked point, then using a 60mm hole saw make a hole to receive the 60mm Jet Inlet.
3. Position the body of the jet behind the SPA wall and make sure the gasket is in place, screw the jet inlet into the body.

### DIMENSIONS:

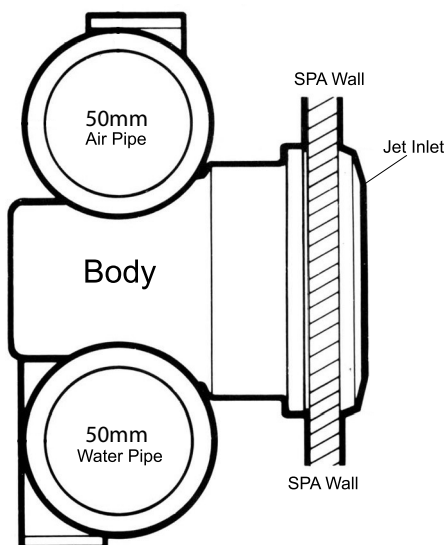

# Single Connection

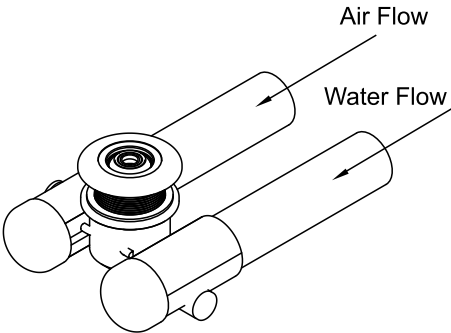

## Dimensions (mm)

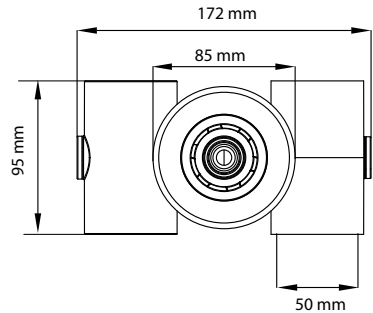

# Continue Connection

