

*"Fitting your
dreams"*



OWNER'S MANUAL

Return Inlet
ABS
Slip Fit / threaded



atecpool.com

ATECPOOL
INTERNACIONAL ESPAÑA

"Fitting your dreams"

Return Inlet ABS Slip Fit

Technical Specifications

Return Inlet ABS Slip Fit

Code: 01592828

Return Inlet ABS threaded

Code: 01592828-2

Return Inlet ABS Threaded for Liner

Code: 01592828-3

Return Inlet ABS Pre-fabricated

Code: 01592836



Important

This manual includes essential information on the safety measures to be implemented for installation and start-up. Therefore, the installer, as well as the user, must read these instructions before beginning installation and start-up.

Dimensions

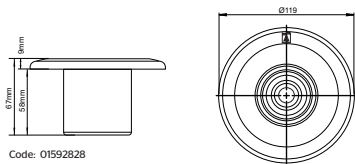

Code: 01592828

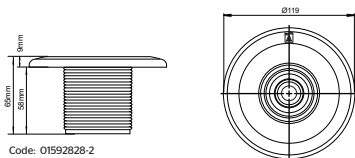

Code: 01592828-2

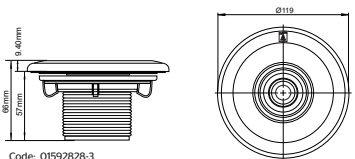

Code: 01592828-3

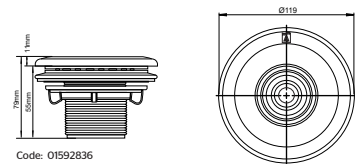

Code: 01592836

Various type of installation

Assembly with threaded wall conduit (code 15658)
Montaje con Pasamuros Roscado (codigo 15658)

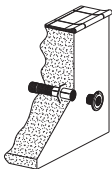

Assembly with wall conduit (Code 15661)
Montaje con Pasamuros (Codigo 15661)

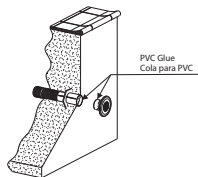

Assembly with tube of PVC 4mm
Montaje con tubo de PVC 4mm.

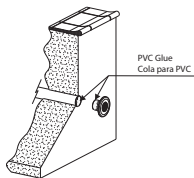

Assembly with threaded wall conduit (15663, 15664 and 15665) and Liner
Montaje con Pasamuros roscado (15663, 15664, 15665) y Liner

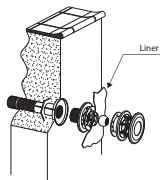

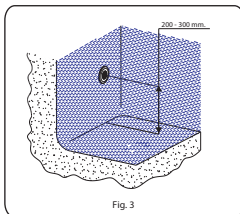
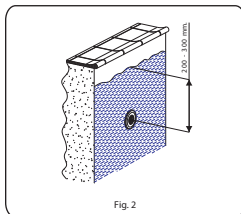
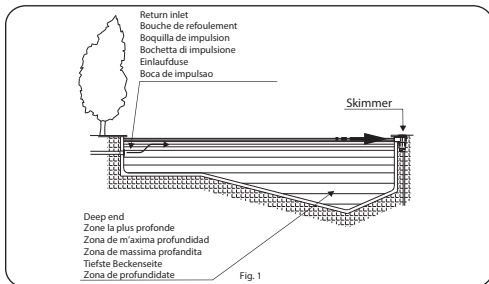

Instruction & Use

IMPORTANT: The instruction manual you are holding includes essential information on the safety measures to be implemented for installation and start-up. Therefore, the installer as well as the user must read the instructions before beginning installation and start-up.

One of the most important factors at the design stage of a swimming pool is the provision for an efficient and uniform recirculation of the pool water. The specific function of the return inlets is to create a current within the pool using the return water from the filtration system. The type of pool and flow required will determine the number of inlets needed. The positioning of the inlets is also important so that a uniform circulation of water is created avoiding the possibility of dead spots. In pools with skimmers (placed opposite the direction of the prevailing winds, figs. 1 & 2), the return inlets should be positioned either on the opposite wall or on the side walls. In those pools where an overflow channel has been installed, it is advisable to install the return inlets either in the bottom of the pool or in the lower part of the side walls. Fig 3

IMPORTANT: All new model return inlets are now supplied with the ball marked with a series of "knock-outs" at 14 mm, 20 mm and 25 mm thus enabling the required flow to be selected at the time of installation. A special tool is available which when used with a mallet will help remove the unwanted part(s) of the ball. (See figure 4)

N.B : Remove the ball from the return inlet and carry out the "knock out" process on a flat surface.

Various type of installation

Prefabricated Polyester Pool Assembly / Montaje Piscina Prefabricada de Poliester

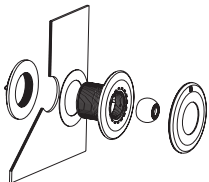

Prefabricated Pool with Liner Assembly / Montaje Piscina Prefabricada con Liner

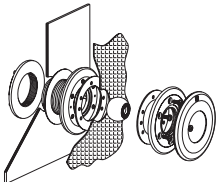

Assembly with threaded wall conduit (15663, 15664 and 15665) and Liner
Montaje con Pasamuros roscado (15663, 15664, 15665) y Liner.

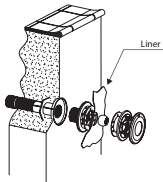



**"Fitting your
dreams"**

Contact us

**Head Office
Spain**

ATECPOOL INTERNACIONAL ESPAÑA

World Trade Center Edificio Sur
2ª Planta - Muelle de Barcelona
E-08039 Barcelona, Spain
Tel. + 34 93 3443358
Email: info@atecpool.com

**United Arab
Emirates**

A-TECHNOLOGIES FZCO

Jebel Ali Free Zone
P.O.Box: 18400 Dubai
United Arab Emirates
Tel. + 971 4 8860880
Fax: + 971 4 8860881
Email: info@a-technologies.com

Sweden

A-TECHNOLOGIES SWEDEN AB

Frillesaasvaegen 83
S-439 62 Frillesaas, Sweden
Tel. + 46 703 655 630
Email: info@atecpoolse

Australia

A-TECHNOLOGIES AUSTRALIA

20 Mercantile Crt.
Molendinar, Qld 4214
P.O. Box: 638, Ashmore City
Tel. + 61 7 55 949111
Fax: + 61 7 55 949266
Email: info@atecpoolau

India

A-TECHNOLOGIES INDIA

613-A, 6th Floor, Ansal Chamber - II
Bhikaji Cama Place, New Delhi
110066, India
Tel. + 91 11 26195948
Email: divender@a-technologies.com

For more product
information:

atecpool.com

join us   

DESIGNED AND ENGINEERED
BY ATECPOOL IN BARCELONA, SPAIN



ATECPOOL
INTERNACIONAL ESPAÑA