

# Pool Access Ladders

## Standard Ladder

Atecpool ladders for residential and commercial swimming pools, made of polished stainless steel (AISI 316 or AISI 304). Handrails in polished stainless steel (Ø42mm) tube. Steps in stainless Steel with anti-slip security. Complete with anchors and earthing accessories.

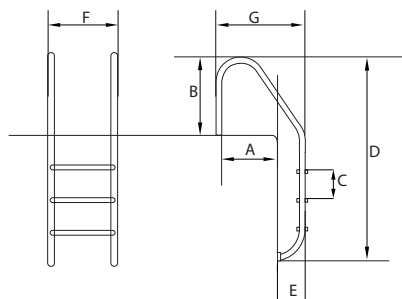

Steps	A	B	C	D	E	F	G
	(mm)	(mm)	(mm)	(mm)	(mm)	(mm)	(mm)
2	410	620	250	1300	180	500	610
3	410	620	250	1550	180	500	610
4	410	620	250	1800	180	500	610
5	410	620	250	2050	180	500	610

### Deluxe S.S. 316



	Code	Weight	Volume
	AISI 316	(kg)	m <sup>3</sup>
2 steps standard	13003215-5	10.0	0.07
3 steps standard	13003215-6	11.8	0.08
4 steps standard	13003215-7	13.2	0.08
5 steps standard	13003215-8	14.0	0.10

### Deluxe S.S. 304



	Code	Weight	Volume
	AISI 304	(kg)	m <sup>3</sup>
2 steps standard	13003215-1	10.0	0.07
3 steps standard	13003215-2	11.8	0.08
4 steps standard	13003215-3	13.2	0.08
5 steps standard	13003215-4	14.0	0.10

## Overflow Ladder

Overflow Ladder with 957mm extended fixing. Made of polished stainless steel (AISI 304 or AISI 316). Handrails in polished stainless steel (Ø42mm) tube and steps are in stainless steel with anti-slip security. Complete with anchors and earthing accessories.

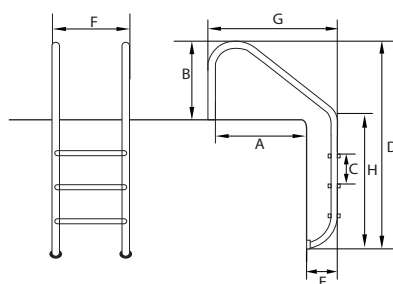

Steps	A	B	C	D	E	F	G	H
	(mm)	(mm)	(mm)	(mm)	(mm)	(mm)	(mm)	(mm)
2	757	610	250	1390	180	500	957	710
3	757	610	250	1640	180	500	957	960
4	757	610	250	1890	180	500	957	1210
5	757	610	250	2140	180	500	957	1460

### Deluxe S.S. 316



	Code	Weight	Volume
	AISI 316	(kg)	m <sup>3</sup>
2 steps overflow	13003215-13	10.0	0.07
3 steps overflow	13003215-14	12.0	0.08
4 steps overflow	13003215-15	14.0	0.08
5 steps overflow	13003215-16	15.0	0.10

### Deluxe S.S. 304



	Code	Weight	Volume
	AISI 304	(kg)	m <sup>3</sup>
2 steps overflow	13003215-9	10.0	0.07
3 steps overflow	13003215-10	12.0	0.08
4 steps overflow	13003215-11	14.0	0.08
5 steps overflow	13003215-12	15.0	0.10